

Business Networking Product Guide

Elevating Businesses with
Enhanced Connectivity



Downloadable
Marketing Resources

Simplify the Management. Optimize the Connection

Functionality, Security and Manageability at a Low Cost with Great Value



The EDIMAX Pro Web Smart Managed Switches goes beyond plug-and-play connectivity, offering convenient of full management capabilities and security features that effortlessly fits into sophisticated IT systems.

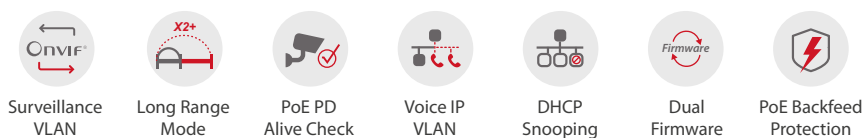

PoE Web Smart Switch

| Model No. | GS-5654PLX | GS-5424PLX | GS-5424PLC V2/ V1 | GS-5216PLC | GS-5210PL | GS-5208PLG V2 | GS-3008P / GS-3005P |
|--|--|--|--|--|--|--|--|
| Gigabit Ethernet | | | | | | | |
| Total Port Count | 54-Port | 28-Port | 28-Port | 18-Port | 12-Port | 10-Port | 8-Port / 5-Port |
| Description | Long Range 54-Port Gigabit PoE+ Web Smart Switch with 6 SFP + 10 Gigabit Ports | Surveillance VLAN 28-Port Gigabit PoE+ Long Range Web Smart Switch with 4 10GbE SFP+ Ports | Surveillance VLAN 28-Port Gigabit PoE+ Long Range Web Smart Switch with 4 Gigabit RJ45/SFP Combo Ports | Surveillance VLAN 18-Port Gigabit PoE+ Long Range Web Smart Switch with 2 Gigabit RJ45/SFP Combo Ports | Surveillance VLAN 12-Port Gigabit PoE+ Long Range Web Smart Switch with 2 Gigabit RJ45 Ports and 2 SFP Ports | Long Range 8-Port Gigabit PoE+ Web Smart Switch with 2 SFP Ports | Long Range 8 or 5-Port Gigabit PoE+ Web Smart Switch with 4 PoE+ Ports |
| Port/Module Slots | | | | | | | |
| GbE / FE | 48 x GbE | 24 x GbE | 24 x GbE | 16 x GbE | 10 x GbE | 8 x GbE | 8 / 5 x GbE |
| SFP/SFP+ Slot | 6 x 10GbE SFP+ | 4 x 10GbE SFP+ | - | - | 2 x SFP | 2 x SFP | - |
| 1000Base Combo RJ-45/SFP | - | - | 4 | 2 | - | - | - |
| PoE Port | 48 | 24 | 24 | 16 | 8 | 8 | 4 |
| PoE Power Management | | | | | | | |
| IEEE 802.3af PoE (15.4W/P) | ✓ | ✓ | ✓ | ✓ | ✓ | ✓ | ✓ |
| IEEE 802.3at PoE (30W/P) | ✓ | ✓ | ✓ | ✓ | ✓ | ✓ | ✓ |
| Power Budget Management UI | ✓ | ✓ | ✓ | ✓ | ✓ | ✓ | ✓ |
| PD Power On/Off Control | ✓ | ✓ | ✓ | ✓ | ✓ | ✓ | ✓ |
| Overloading Protecting | ✓ | ✓ | ✓ | ✓ | ✓ | ✓ | ✓ |
| Power Backfeed Protection | ✓ | ✓ | ✓ | ✓ | ✓ | ✓ | ✓ |
| Long Range PoE 200M* | ✓ | ✓ | ✓ | ✓ | ✓ | ✓ | ✓ |
| Total PoE Power Budget | 400W | 400W | 400W | 280W | 110W | 85W | 60W |
| Performance | | | | | | | |
| Packet Buffer, bit | 16M | 12M | 4.1M | 4.1M | 4.1M | 1.5M | 1.5M / 1M |
| MAC Address | 32K | 16K | 8K | 8K | 8K | 4K | 4K |
| Jumbo Frame, Bytes | 12K | 12K | 9K | 9K | 9K | 9K | 9K |
| Backplane bandwidth | 216Gbps | 128Gbps | 56Gbps | 36Gbps | 24Gbps | 20Gbps | 16Gbps / 10Gbps |
| Forwarding Rate | 160.7Mpps | 95.2Mpps | 41.6Mpps | 26.7Mpps | 17.8Mpps | 14.8Mpps | 11.9Mpps / 7.4Mpps |
| Management | | | | | | | |
| Web-Based/SNMP | Web-Based | Web-Based | Web-Based | Web-Based | Web-Based | Web-Based | Web-Based |
| Features | | | | | | | |
| ONVIF Surveillance VLAN | - | ONVIF® Comformant | ONVIF® Comformant (V2 only) | ONVIF® Comformant | ONVIF® Comformant | - | - |
| IEEE 802.1q VLAN | ✓ | ✓ | ✓ | ✓ | ✓ | ✓ | ✓ |
| IEEE 802.1d/w STP/RSTP | ✓ | ✓ | ✓ | ✓ | ✓ | ✓ | ✓ |
| IEEE 802.3az Energy Efficient Ethernet | ✓ | ✓ | ✓ | ✓ | ✓ | ✓ | ✓ |
| Trunking Group | 8 | 8 | 8 | 8 | 8 | 8 | 1 |
| LACP | ✓ | ✓ | ✓ | ✓ | ✓ | ✓ | ✓ |
| QoS/Priority Queues | ✓ | ✓ | ✓ | ✓ | ✓ | ✓ | ✓ |
| IGMP Snooping | ✓ | ✓ | ✓ | ✓ | ✓ | ✓ | ✓ |
| Storm Control | ✓ | ✓ | ✓ | ✓ | ✓ | ✓ | ✓ |
| Port Mirroring | ✓ | ✓ | ✓ | ✓ | ✓ | ✓ | - |
| Loopback Detection | ✓ | ✓ | ✓ | ✓ | ✓ | ✓ | ✓ |
| PoE PD Alive Check | ✓ | ✓ | ✓ | ✓ | ✓ | - | - |
| Dual Firmware | ✓ | ✓ | ✓ | ✓ | ✓ | - | - |
| Voice VLAN | ✓ | ✓ | ✓ | ✓ | ✓ | - | - |
| DHCP Snooping | ✓ | ✓ | ✓ | ✓ | ✓ | - | - |
| Long Range PoE 200M* | ✓ | ✓ | ✓ | ✓ | ✓ | ✓ | ✓ |
| Fan Type | 4 x Fans with Intelligent Thermal Controller | 2 x Fans with hot-swappable fan tray | 2 x Fans with hot-swappable fan tray | 1 x Fan with hot-swappable fan tray | Fanless | Fanless | Fanless |
| Power Type | Internal Power | Internal Power | Internal Power | Internal Power | Internal Power | Internal Power | External Power |
| Physical | | | | | | | |
| Dimension (LxWxH) | 441x330x45mm | 441x270x45mm | 441x270x45mm | 441x196x44mm | 330x230x44mm | 265x184x44mm | 265x184x44mm 193x84x26mm |
| Mounting Type | Rack Mount | Rack Mount | Rack Mount | Rack Mount | Rack Mount | Rack Mount | Wall Mount |

* Guaranteed PoE long distance to 200 meters.

Guaranteed PoE Long Distance to 200 Meters

Long Range Flexible PoE Deployment, Exceptional for IP Surveillance Solution

The EDIMAX dedicated long range PoE switches supports PoE-enabled devices, saving more money by reducing power cable deployment costs, in addition with easy hardware DIP switches that can further setup port-based VLAN (port isolation) and QoS.



Guarantee PoE Distance 200M



Easy Hardware QoS



Innovative Port-Based VLAN



Flexible PoE Deployment



New



10 GbE



10 GbE



New

| PoE Unmanaged Switch | | | |
|--|--|--|--|
| Model No. | GS-1008P V2 / GS-1008PL V2 | ES-1008P V2 | ES-5104PH V2 |
| | Gigabit Ethernet | Fast Ethernet | |
| Total Port Count | 8-Port | 8-Port | 5-Port |
| Description | 8-Port Gigabit PoE+ Switch with DIP Switch | 8-Port Fast Ethernet PoE+ Switch with DIP Switch | 5-Port Fast Ethernet Switch with 4 PoE+ Ports & DIP Switch |
| Port/Module Slots | | | |
| GbE / FE | 8 x GbE | 8 x FE | 5 x FE |
| PoE Port | 8 | 8 | 4 |
| PoE Features | | | |
| IEEE 802.3af PoE | v | v | v |
| IEEE 802.3at PoE | v | v | v |
| PD Classification | v | v | v |
| Overloading Protecting | v | v | v |
| Long Range PoE Extend Mode | v (DIP Switch) | v (DIP Switch) | v (DIP Switch) |
| Total PoE Power Budget | 130W / 70W | 130W | 60W |
| Performance | | | |
| Packet Buffer, bit | 1.5M | 448K | 448K |
| MAC Address | 2K/ 4K | 1K | 1K |
| Jumbo Frame, Bytes | 9K | - | - |
| Features | | | |
| IEEE 802.1q VLAN | v (DIP Switch) | v (DIP Switch) | v (DIP Switch) |
| IEEE 802.3az Energy Efficient Ethernet | v | v | v |
| QoS | v (DIP Switch) | v (DIP Switch) | v (DIP Switch) |
| Long Range PoE 200M* | v (DIP Switch) | v (DIP Switch) | v (DIP Switch) |
| Fan Type | Fanless | Fanless | Fanless |
| Power Type | Internal Power | Internal Power | External Power |
| Physical | | | |
| Dimension (LxWxH) | 265x184x44mm | 265x184x44mm | 121x75x26mm |
| Mounting Type | Rack Mount | Rack Mount | Wall Mount |

* Guaranteed PoE long distance to 200 meters.



New



New



New



New

| Unmanaged Switch | | | | |
|--|----------------------|---|-------------------------|--------------------------------|
| Model No. | GS-1005BE | GS-1026 V3 | GS-1016 V2 | GS-1008E V2 / GS-1005E |
| | 2.5 Gigabit | Gigabit Ethernet | | |
| Total Port Count | 5-Port | 26-Port | 16-Port | 8-Port / 5-Port |
| Description | 5-Port 2.5GbE Switch | 24-Port Gigabit Switch with 2 SFP Ports | 16-Port Gigabit Switch | 8-Port / 5-Port Gigabit Switch |
| Port/Module Slots | | | | |
| GbE / FE | 5 x 2.5GbE | 24 x GbE | 16 x GbE | 8 / 5 x GbE |
| SFP/SFP+ Slot | - | 2 x SFP | - | - |
| Performance | | | | |
| Packet Buffer, bit | 12M | 4.1M | 4.1M | 192KB / 128KB |
| MAC Address | 16K | 8K | 8K | 4K / 2K |
| Jumbo Frame, Bytes | 12K | 10K | 10K | 9K |
| Features | | | | |
| IEEE 802.3az Energy Efficient Ethernet | v | v | v | v |
| Fan Type | Fanless | Fanless | Fanless | Fanless |
| Power Type | External Power | Internal Power | Internal Power | External Power |
| Physical | | | | |
| Dimension (LxWxH) | 160x110x26mm | 441x131x44mm | 215x133x42mm | 154x85x26mm / 121x75x26mm |
| Mounting Type | Wall Mount | Rack Mount | Rack Mount / Wall Mount | Wall Mount |

| Accessories | | |
|-------------|--|---|
| Model No. | GP-102IT | GP-101IT |
| | PoE Injector | |
| Description | IEEE 802.3bt Gigabit PoE++ Injector, up to 60W | IEEE 802.3at Gigabit PoE+ Injector, up to 30W, Wall-Mount |



New



New

| GP-101ET | GP-101ST | MG-10G / MG-1000 Series | EA1 Series |
|------------------------------------|------------------------------------|--------------------------------|--------------------------------|
| PoE Extender | PoE Splitter | SFP Transceiver | SFP+ DAC Cable |
| IEEE 802.3at Gigabit PoE+ Extender | IEEE 802.3at Gigabit PoE+ Splitter | 10GbE or 1GbE SFP+/SFP Modules | 10GbE SFP+ Direct Attach Cable |



10 GbE



10 GbE

New

| EN-9320SFP+ | EN-9320TX-E V2 | EN-9225TX-E |
|---|--|---|
| PCI-E Card | | |
| 10 Gigabit Ethernet SFP+ PCI Express Server Adapter | 10 Gigabit Ethernet PCI Express Server Adapter | 2.5 Gigabit Ethernet PCI Express Server Adapter |



10 GbE



10 GbE



2.5 GbE

New

Robust Industrial Managed Switch

Durable, Reliable, Flexible & Smart Network for Harsh Environments

Certified to withstand harsh environment and provides reliable network connection, the industrial switch is ideal for industrial networks such as automotive, factory automation, oil and gas, mining, military, transportation, substation, energy and outdoor applications of railways, roads, tunnels, smart cities, city surveillance and traffic monitoring.



Certified Ruggedized Design



High/Low Temperature Resistance



Reliable Dual Redundancy



IGS-5416P, IGS-5408P, IGS-5208

| Model No. | IGS-5416P | IGS-5408P | IGS-5208 |
|----------------------------------|---|--|---|
| | Gigabit Ethernet | | |
| Total Port Count | 20-Port | 12-Port | 10-Port |
| Description | Industrial 16-Port Gigabit PoE+ Web Managed Switch with 4 SFP Slots | Industrial 8-Port Gigabit PoE+ Web Managed Switch with 4 SFP Slots | Industrial 8-Port Gigabit Web Managed Switch with 2 SFP Slots |
| Hardware | | | |
| 10/100/1000Base-T | 16 | 8 | 8 |
| SFP/SFP+ Slot | 4 x SFP | 4 x SFP | 2 x SFP |
| PoE Port | 8 | 8 | - |
| Console Port | v | v | v |
| USB Port | 1x USB 2.0 storage for firmware update, configuration backup, restore, boot up and system log | | |
| DI/DO | DI x 1, DO x 1 | DI x 1, DO x 1 | DI x 1, DO x 1 |
| Power Redundancy | Redundant Dual DC 48V-57V | Redundant Dual DC 48V-57V | Redundant Dual DC 12V-48V |
| Reserve Polarity Protection | v | v | v |
| Overload Current Protection | v | v | v |
| Alarm Contact | 1A@24VDC | 1A@24VDC | 1A@24VDC |
| Housing | Ruggedized aluminum alloy case, IP30-rated | | |
| Operation Temperature Range | -40 ~ 75°C | -40 ~ 75°C | -40 ~ 75°C |
| MTBF (Mean Time Between Failure) | >100,000 hours | >100,000 hours | >100,000 hours |
| Fan Type | Fanless | Fanless | Fanless |
| Performance | | | |
| Switching Capacity | 40Gbps | 24Gbps | 20Gbps |
| Packet Buffer, bit | 12M bit | 12M bit | 12M bit |
| MAC Address | 16K | 16K | 16K |
| Jumbo Frame, Bytes | 16K | 16K | 16K |
| Forwarding Rate | 29.76Mpps | 17.85Mpps | 14.88Mpps |
| PoE Power Management | | | |
| Power Budget Management UI | v | v | - |
| PD Alive Check | v | v | - |
| PoE Scheduling | v | v | - |
| Total PoE Power Budget | 240W | 240W | - |
| Management | | | |
| Web Based Management | v | v | v |
| Telnet | v | v | v |
| SNMP (v1/v2c/v3) | v | v | v |
| Physical | | | |
| Dimension (LxWxH) | 90.8 x 145 x 113 mm | 72.2 x 145 x 113 mm | 72.2 x 145 x 113 mm |
| Mounting Type | DIN-Rail | DIN-Rail | DIN-Rail |
| Certification & Standard | | | |
| Vibration, Shock, Free-Fall | IEC60068-2-6, IEC60068-2-27, IEC60068-2-32 | | |
| EMC | 61000-6-2, 61000-6-4 | 61000-6-2, 61000-6-4 | 61000-6-2, 61000-6-4 |
| EMS | IEC61000-4-2 (ESD), IEC61000-4-3 (RS), IEC61000-4-4 (EFT), IEC61000-4-5 (Surge), IEC61000-4-6 (CS), IEC61000-4-8 (Magnetic Field) | | |
| EMI | CE, FCC | CE, FCC | CE, FCC |
| Standards | IEEE 802.1Q VLAN, IEEE 802.1D STP, IEEE 802.1w RSTP, IEEE 802.1s MSTP, IEEE 802.3ad LACP, IEEE 802.1AB LLDP, ITU-T G.8032/Y.1344 ERPS | | |

For Harsh Environments in Industrial IoT (IIoT) and Smart City



Manufacturing, Automotive



Energy Plant



Transportation, Smart City



Factory Automation

Exceptional Business Wi-Fi. Always Stays Connected

Easy Deployment, Built for Professional Heavy Users

A series of business grade EDIMAX Pro Access Points allows businesses to build a reliable, cost-effective wireless network that goes from indoors to outdoors and long range Wi-Fi connectivity. The EDIMAX Pro Wi-Fi drives progress, maintain employee productivity and customer satisfaction.

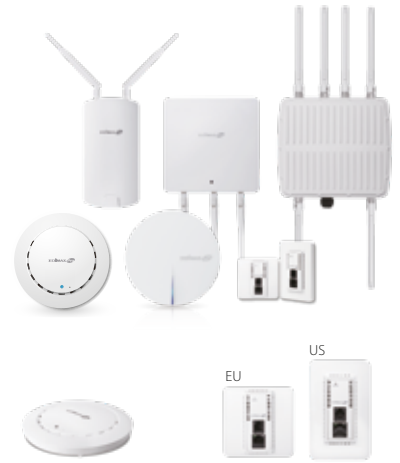

High Speed
& Efficiency



Wide
Coverage



Reliable
Connection



High Density
for BYOD



Secure
Access



Free & Flexible
Management



| Indoor Access Point | | | | | | | | |
|----------------------------------|---------------|---|---|---|--|--|---|--|
| Model No. | | CAX1800 | CAP1750 | CAP1300 | CAP1200 | CAP300 | IAP1200 | |
| | | Ceiling Mount | | | | | In-Wall | |
| Description | | 2x2 AX Dual-Band Ceiling Mount PoE | 3x3 AC Dual-Band Ceiling Mount PoE | 2x2 AC Wave 2 Dual-Band Ceiling Mount PoE | 2x2 AC Dual-Band Ceiling Mount PoE | 2x2 N Ceiling Mount PoE | 2x2 AC Dual-Band In-Wall PoE | |
| LAN Interface | | GbE x 1 | GbE x 1 | GbE x 2 | GbE x 1 | GbE x 1 | GbE x 2, RJ11 x 2 | |
| PoE | | 802.3af | 802.3at | 802.3af (Support 802.3at) | 802.3af (Support 802.3at) | 802.3af (Support 802.3at) | 802.3af (Support 802.3at) | |
| Antenna | | 2 x Built-In PIFA (2 x 2.4Ghz (2.2dBi), 2 x 5GHz (2.9dBi)) | 6 x Built-in PIFA (3 x 2.4GHz (4.38dBi), 3 x 5GHz (5.34dBi)) | 4 x Built-in PIFA (2 x 2.4GHz (4dBi), 2 x 5GHz (5dBi)) | 4 x Built-in PIFA (2 x 2.4GHz (2.82dBi), 2 x 5GHz (4dBi)) | 2 x Built-in PIFA (2.4GHz (2.82dBi)) | 2 x Built-in PIFA (2.4GHz (2.14dBi), 5GHz (3.8dBi)) | |
| Power Consumption (Full Loading) | Power Adapter | 12V, 2A | 12V, 2A | 12V, 1A | 12V, 1A | 12V, 1A | - | |
| | PoE | 12W | 15W; 19.2W (With USB) | 11W | 11W | 11W | 8W | |
| No. of Radio | | 2 | 2 | 2 | 2 | 1 | 2 | |
| Number of SSID (2.4G+5G) | | 16+16 | 16+16 | 16+16 | 16+16 | 16+0 | 16+16 | |
| Maximum Data Speed | | 574+1201Mbps | 450+1300Mbps | 400+867Mbps | 300+867Mbps | 300Mbps | 300+867Mbps | |
| Concurrent Clients | | Up to 128 Per Radio | Up to 50 Per Radio | Up to 100 Per Radio | Up to 50 Per Radio | Up to 50 Per Radio | Up to 50 Per Radio | |
| 802.11 r /k Roaming | | v | v | v | v (only 5G) | - | - | |
| Beamforming / AirTime Fairness | | v | - | v | - | - | - | |
| Mode | | · Standalone AP mode · Master AP mode: Manage 16 APs · Managed AP mode: Be managed by CAX1800/WAP1750/CAP1300 Master AP with NMS & APC500 | · Standalone AP mode · Master AP mode: Manage 16 APs · Managed AP mode: Be managed by CAP/WAP series /OAP1750 Master AP with NMS & APC500 | · Standalone AP mode · Master AP mode: Manage 16 APs · Managed AP mode: Be managed by CAP/WAP series /OAP1750 Master AP with NMS & APC500 | · Standalone AP mode · Master AP mode: Manage 8 APs · Managed AP mode: Be managed by CAP/WAP series /OAP1750 Master AP with NMS & APC500 | · Standalone AP mode · Master AP mode: Manage 8 APs · Managed AP mode: Be managed by CAP/WAP series /OAP1750 Master AP with NMS & APC500 | · Standalone AP mode · Managed AP mode: Be managed by CAP/WAP series /OAP1750 Master AP with NMS & APC500 · For hotel / apartment building deployment | |



| Indoor and Outdoor Access Point | | | | | | |
|----------------------------------|---------------|---|---|---|---|---|
| Model No. | | WAP1750 | WAP1200 | OAP1750 | OAP1300 / OAP1300 V2 | OAP900 |
| | | Wall Mount | | | Outdoor Pole-Mount | |
| Description | | 3x3 AC Dual-Band Wall Mount PoE | 2x2 AC Dual-Band Wall Mount PoE | 3x3 AC Dual-Band Outdoor PoE | 2x2 AC Wave 2 Dual-Band Outdoor PoE | 2x2 AC 5GHz Outdoor PoE |
| LAN Interface | | GbE x 2 | GbE x 2 | GbE x 1 | GbE x 2 | GbE x 2 |
| PoE | | 802.3at(In)/802.3af(Out) 10W | 802.3at | 802.3at | 802.3at, (LAN1 PoE in, LAN2 PoE out) | Passive PoE, (LAN1 PoE in, LAN2 PoE out) |
| Antenna | | 3 x External (2.4GHz (2dBi), 5GHz (2dBi)) | 2 x External (2.4GHz (2dBi), 5GHz (2dBi)) | 6 x External (2.4GHz (4dBi), 5GHz (6dBi)) | V1: 2 x External (2.4GHz (5dBi), 5GHz (5dBi)) V2: 2 x Internal (2.4GHz (5dBi), 5GHz (14dBi)) | 2 x Internal Patch Antenna, 5GHz (15dBi), 2 x SMA Connector for Ext. Ant. |
| Power Consumption (Full Loading) | Power Adapter | 12V, 4A | 12V, 2.5A | - | - | - |
| | PoE | 15W (Exclude PoE-Out) | 12W | 22W | 15W | 10.6W (Passive PoE) |
| No. of Radio | | 2 | 2 | 2 | 2 | 1 |
| Number of SSID (2.4G+5G) | | 16+16 | 16+16 | 16+16 | 16+16 | 0+16 |
| Maximum Data Speed | | 450+1300Mbps | 300+867Mbps | 450+1300Mbps | 400+867Mbps | 900Mbps |
| Concurrent Clients | | Up to 50 Per Radio | Up to 50 Per Radio | Up to 50 Per Radio | Up to 100 Per Radio | Up to 50 Per Radio |
| 802.11 r /k Roaming | | v | v | v | v | v |
| Beamforming / AirTime Fairness | | - | - | - | v | - |
| Mode | | <div><div>• Standalone AP mode</div><div>• Master AP mode: Manage 16 APs</div><div>• Managed AP mode: Be managed by CAP/WAP series /OAP1750 Master AP with NMS & APC500</div></div> | <div><div>• Standalone AP mode</div><div>• Master AP mode: Manage 16 APs</div><div>• Managed AP mode: Be managed by CAP/WAP series /OAP1750 Master AP with NMS & APC500</div></div> | <div><div>• Standalone AP mode</div><div>• Master AP mode: Manage 16 APs</div><div>• Managed AP mode: Be managed by CAP/WAP series /OAP1750 Master AP with NMS & APC500</div></div> | <div><div>• Standalone AP mode</div><div>• Managed AP mode: Be managed by CAP/WAP series /OAP1750 Master AP with NMS & APC500</div></div> | <div><div>• Standalone AP mode</div><div>• Managed AP mode: Be managed by CAP/WAP series /OAP1750 Master AP with NMS & APC500</div></div> |

Superior High-Speed & Performance Wi-Fi System

AX1800 Wi-Fi 6, Pre-Configured Easy Setup, Expandable Wi-Fi

primeAX 1-2-3

The PrimeAX 1-2-3 Wi-Fi system comes with the IEEE 802.11ax Wi-Fi 6 technology for wireless speeds up to 1800Mbps (574Mbps at 2.4GHz and 1201Mbps at 5GHz). Expect enterprise-grade performance and build quality, combined with user-friendly operation, easy deployment, super-fast wireless speed, an extensive feature set and a practical, ceiling-mount design make an ideal dual-band solution for enterprise environments.

The PrimeAX 1-2-3 2-pack kit equipped with pre-configured Master and Slave AX1800 APs achieves seamless Wi-Fi coverage and eliminates Wi-Fi dead zones. The built-in smart wizard makes network setup a breeze, you can easily configure and find your paired devices via the Device Discovery Tool which also includes security features (WPA/WPA2/WPA3 and more). What's more, the PrimeAX 1-2-3 featured AX technology such as BSS coloring, DL/UL OFDMA, DL/UL MU-MIMO, TWT (provides improvements in throughput), multi-device support, and Wi-Fi spectrum efficiency for streaming, gaming, media sharing, increases battery life efficiency for devices and reduce power consumption.



802.11AX Technology Features and Benefits

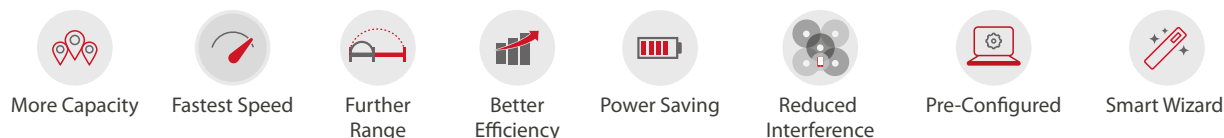

Smart and Easy Setup!



1. Power on the PrimeAX 1-2-3 APs and connect the APs to the existing network switch. (APs can be powered on by PoE)
2. Access the Smart Wizard with a web browser. (Dedicated IP address listed on the label.)
3. Follow the Smart Wizard instructions to configure the Wi-Fi networks in just a few steps

Ordering Information:

2-pack:

PrimeAX 1-2-3 (Master) &
PrimeAX 1-2-3 (Slave)



1-pack:

PrimeAX +1



Expandable Wi-Fi System

PrimeAX 1-2-3 includes 2 APs and is expandable with PrimeAX +1 Add-on AP, up to a total of 16 APs.

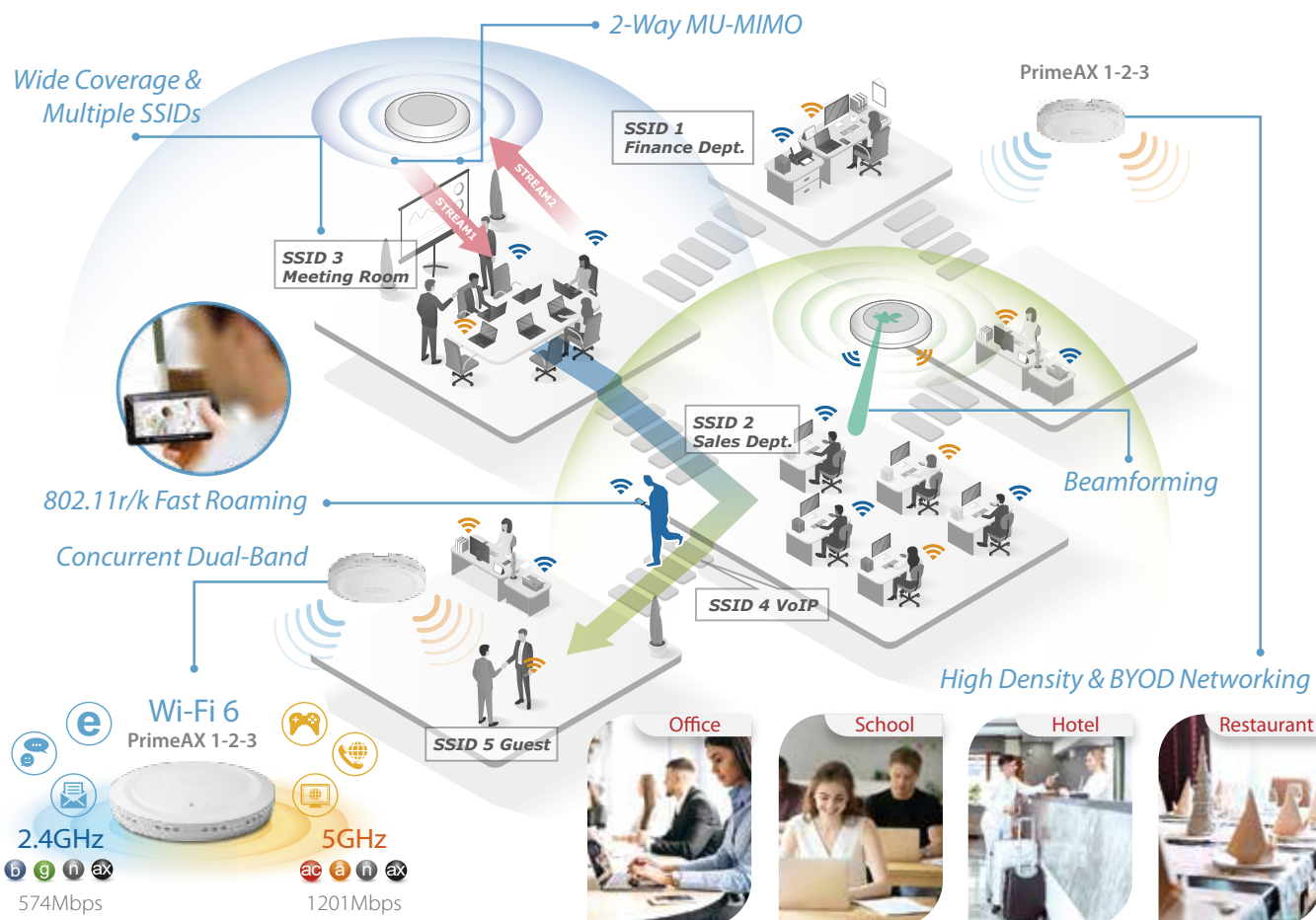

Smart, Secure and Self-Managed Wi-Fi

Easy, Complete, Expandable Office Wi-Fi System for Business and Home from Indoor to Outdoor

The Office 1-2-3 Office Wi-Fi System starter kit comes with three pre-configured access points that can communicate between themselves with self-managed functions for easy setup. The system is expandable with CAP1300 Office +1 (indoor ceiling-mount)/OAP1300 Office +1 (outdoor) Add-on AP, up to a total of 16 APs with zero configuration*. Built-in with the AP management software, no need for server or controller software and no extra license fee.



* Zero configuration: Once the Office 1-2-3 Master AP had been installed, the slave APs or add-on APs are automatically configured with master AP while connected to the existing network.

OFFICE 1-2-3



Easy Setup!

Get Your Office Wi-Fi Up and Running in Minutes!

-  Connect the Office 1-2-3 / Office +1 APs to the existing network via switch. (APs can be powered on by PoE)
-  Download the IP Finder utility and the system will find the Office 1-2-3 APs automatically.
-  Follow the wizard instructions of web- and icon-based UI and easily configure the Wi-Fi network in just a few steps.

Secured, Separated 3 Wi-Fi Networks

Expandable Indoor & Outdoor Wi-Fi System up to 16 APs

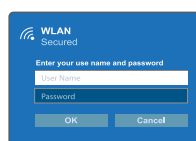

Office Network

Each employee has his/ her own Wi-Fi access account and password.

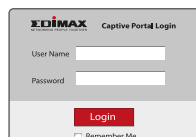

Guest Network

Login to guest network via captive portal and SMS authentication.

| Device Name | MAC Address |
|-------------|-------------------|
| IPCAM1 | 00:34:45:66:1A:01 |
| IPCAM2 | 00:34:45:66:1A:02 |
| IPCAM3 | 00:34:45:66:1A:03 |
| Printer1 | 00:34:45:66:1A:04 |
| Printer2 | 00:34:45:66:1A:05 |

Device Network

Access Control List (ACL) to manage wireless equipments.

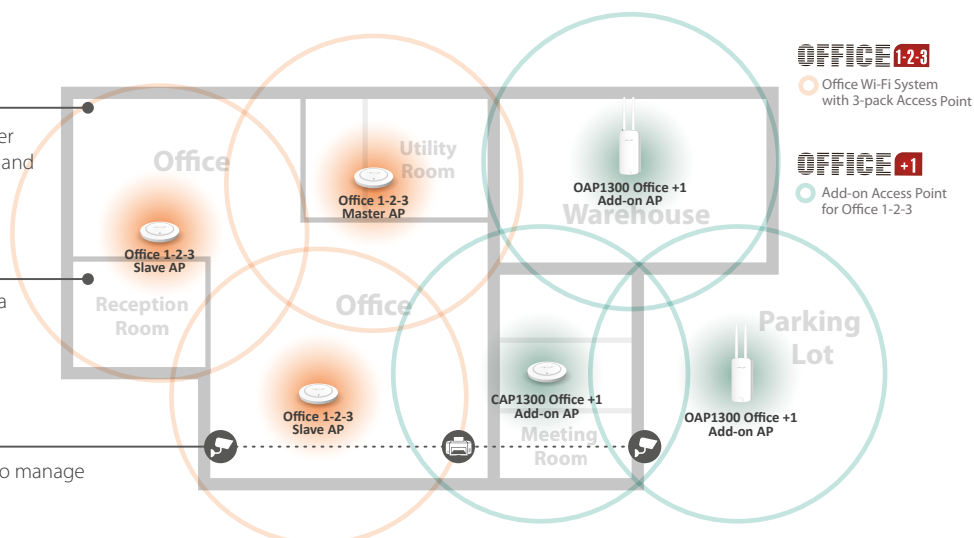

Dedicated Office Wi-Fi System for SMBs

Suitable for a wide range of office spaces such as the working area, meeting room, open space, lobby, warehouse, parking lot and others from indoor to outdoor as well as the home office and large house.



Ordering Information:

Office 1-2-3 & Office +1 Product Family

Office 1-2-3
Wi-Fi System, 3-Pack



Office 1-2-3 Master AP
CAP1300 Office +1
Indoor Add-on AP



OAP1300 Office +1
Outdoor Add-on AP



Choice of Network Management



| Model No. | APC500 | NMS |
|----------------|---|---|
| Where to Use | For SMB/SME Level | For Small Project and Offices |
| Highlight | <ul style="list-style-type: none"> Manages up to 200 EDIMAX Pro APs Stand-Alone Box Centralized & Remote Management Support Gigabit Ports and USB 3.0 Built-in Radius Server | <ul style="list-style-type: none"> Manages up to 8 or 16 Edimax Pro APs (One Master AP Manages Other APs) Free, Built-in with EDIMAX Pro CAP/WAP/CAX Series and OAP1750 AP AP Array Architecture Built-in Radius Server, No Need for Extra Server and Hardware Controller |
| Applied Models | All EDIMAX Pro APs (except Office 1-2-3 series) | All EDIMAX Pro APs (Built-in with CAP/WAP/CAX series and OAP1750 APs) |



New

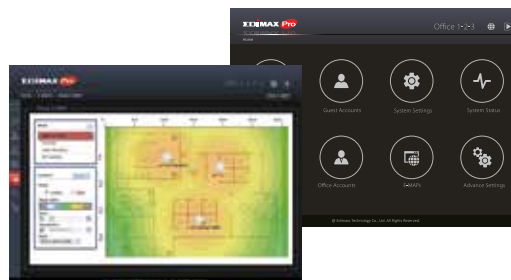

| Model No. | PrimeAX 1-2-3 | OFFICE 1-2-3 |
|----------------|--|---|
| Where to Use | For offices, schools, hotels, hospitals, retail shops or shopping malls with High-Speed | For Small Business and Offices |
| Highlight | <ul style="list-style-type: none"> Managed up to 16 PrimeAX 1-2-3 series APs (One Master AP Manages Other APs) Free, Built-in with PrimeAX 1-2-3 series AP | <ul style="list-style-type: none"> Manages up to 16 Office 1-2-3 series APs (One Master AP Manages Other APs) Free, Built-in with Office 1-2-3 series AP. |
| Applied Models | All PrimeAX 1-2-3 series APs Only | All Office 1-2-3 series APs Only |



www.edimax.com

Edimax Technology Co., Ltd.
No. 278, Xinhua 1st Rd., Neihu Dist.,
Taipei City, Taiwan
Email: support@edimax.com.tw

Edimax Technology Europe B.V.
Fijenhof 2, 5652 AE Eindhoven,
The Netherlands
Email: support@edimax.nl

Edimax Computer Company
530 Technology Drive Suite 100, Irvine,
CA 92618, USA
Email: support@edimax.us